

Site Visit Preparation

To help us determine the potential childcare capacity of a facility it is helpful to complete the following work:

1. Draw a rough sketch of the building showing each room intended for Child Care space

- Label the rooms by their intended purpose
- Note each rooms' dimensions (length and width) and square footage (length x width)
- Draw and label doors, toilets, sinks as well as any other built in features

2. Draw a secondary rough sketch showing the entire property. Document streets and names.

- Note the dimensions of the outdoor play space. (If applicable, document the fence and fence height)
- Label any other areas on the property that are intended for Child Care use
- Indicate additional structures on the property (i.e.; garage, sheds, etc.)
- Label the intended Child Care parking area and number of allotted spaces

EXAMPLES

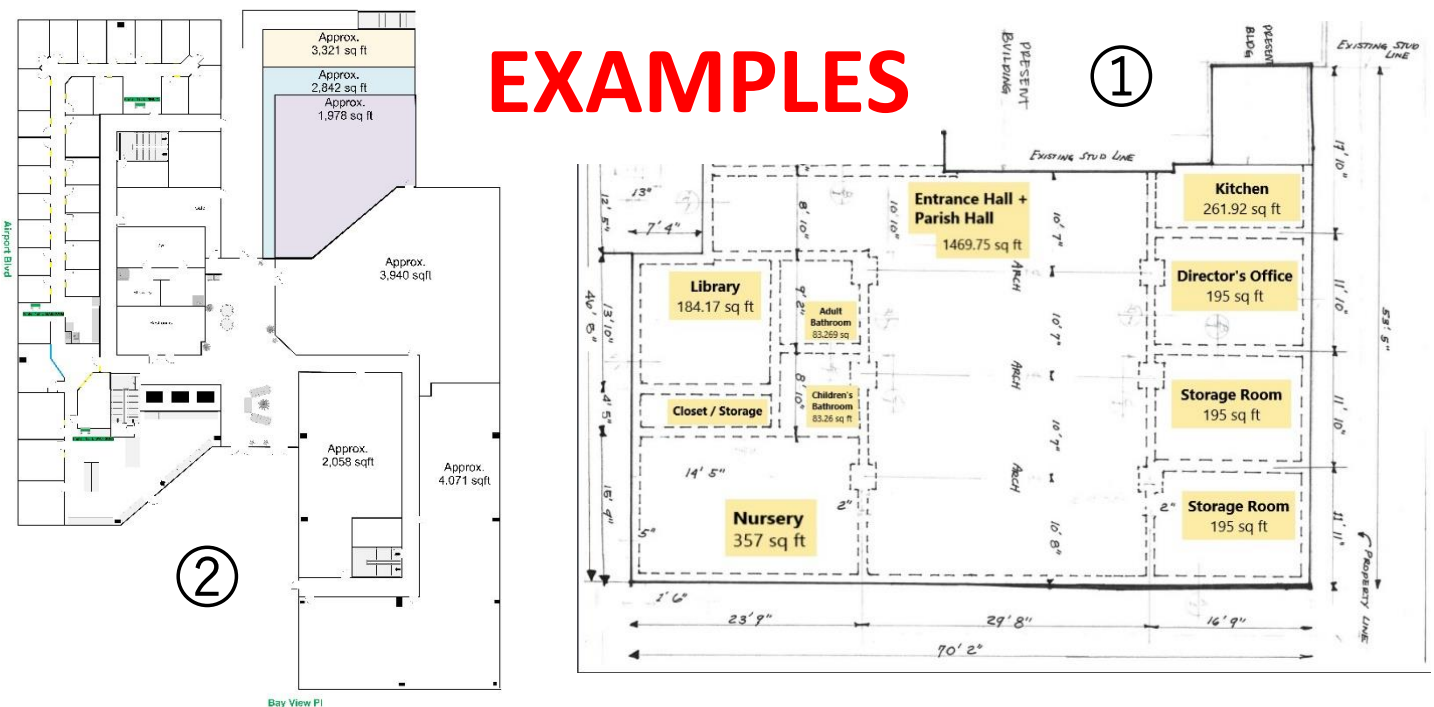

Minimum Licensing requirements for a Child Care Center

- 35 sq ft of play space per child (For a high-quality environment, 45-50 sq ft of play space is recommended)
- 75 sq ft of playground space per child (Spaces with limited outdoor space can request a waiver)
- One toilet and one hand washing sink for every 15 children enrolled
- 1 teacher for every 12 preschoolers (2-5 years old) enrolled
- One extra bathroom (toilet and sink) to be used by staff and "sick child"